



Park View

at FULLERTON

Apartment Homes for Seniors

Your New Lifestyle Begins Here

Services

- Social and recreational activities
- Education and health seminars
- Monthly community updates with management
- 24 hour maintenance
- Convenient business services, including stamps for purchase and use of office equipment
- Assistance with small home improvement projects
- Accessibility to food programs such as Meals on Wheels
- Transportation provided for community events

Conveniently Located Near

- Shopping Malls
- Health Care providers
- Restaurants
- Senior Center
- Movie Theatres

Community features

- Beautifully landscaped courtyard and patio
- Electronically controlled lobby entrance
- Community room with kitchen
- Game/Activity room
- Lending library
- Computer center
- Beauty and Barber services
- Laundry facility with convenient lounge
- Elevator

Apartment features

- Bathroom with enhanced safety features
- Monitored emergency pull cords
- Smoke alarms and fire sprinklers
- Fully-equipped kitchen
- Mini-blinds on all windows
- Handicapped accessible and adaptable



Park View at Fullerton

4300 Cardwell Avenue · Baltimore, Maryland 21236

Phone: (410) 663-0665 · Fax: (410) 663-9408

Email: parkviewfullerton@sheltergrp.com



Floor Plans & Directions

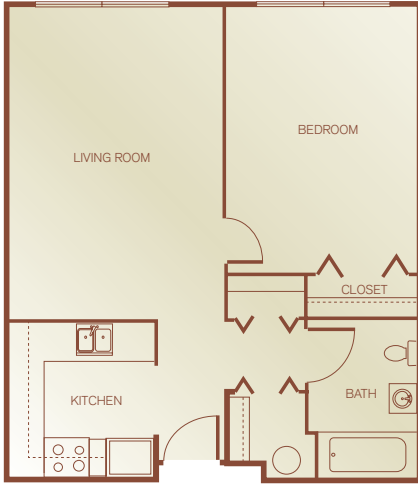

Plan B
1 Bedroom, 1 Bath
612 Square Feet

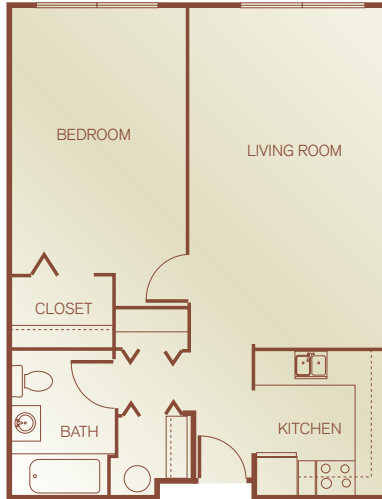

Plan A
1 Bedroom, 1 Bath
681 Square Feet



Plan B with Study
1 Bedroom, 1 Bath and Study
723 Square Feet

<i>Apartment Availability</i>
<i>Available Apartment</i>
<i>Monthly Rent</i>
<i>Security Deposit</i>
<i>Application Fee</i>

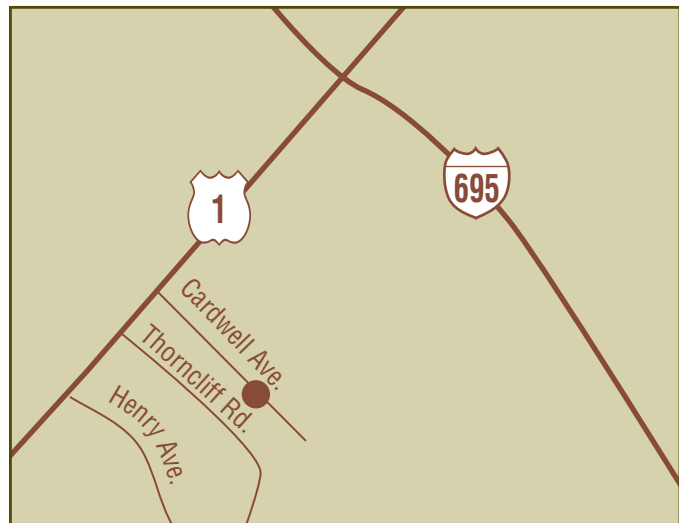

From I-695 Baltimore Beltway take the US-1 South (exit number 32A) toward Overlea. Turn onto US-1/Belair Rd. Turn left onto Cardwell Ave.

Park View is committed to Equal Housing Opportunities for people of all races, religions, ethnic groups, sexual orientation and disabilities, and all others protected by federal, state, or local law.

Park View at Fullerton

4300 Cardwell Avenue · Baltimore, Maryland 21236
Phone: (410) 663-0665 · Fax: (410) 663-9408
Email: parkviewfullerton@sheltergrp.com

