



# Park View

at ELLICOTT CITY

Apartment Homes for Seniors

## Your New Lifestyle Begins Here

### *Services*

- Social and recreational activities
- Education and health seminars
- Monthly community updates with management
- 24 hour maintenance
- Convenient business services, including stamps for purchase and use of office equipment
- Assistance with small home improvement projects
- Accessibility to food programs such as Meals on Wheels
- Transportation available through local bus services

### *Conveniently Located Near*

- Shopping Centers
- Ellicott City Senior Center
- Howard County General Hospital
- Howard Community College
- Restaurants

### *Community features*

- Beautifully landscaped courtyard and patio
- Electronically controlled lobby entrance
- Community room with kitchen
- Game/Activity room
- Lending library and computer center
- Exercise room
- Wellness suite
- Beauty and Barber services
- Laundry facility with convenient lounge
- Elevator

### *Apartment features*

- Bathroom with enhanced safety features
- Monitored emergency pull cords
- Smoke alarms and fire sprinklers
- Fully-equipped kitchen
- Mini-blinds on all windows
- Handicapped accessible and adaptable



### *Park View at Ellicott City*

8720 Ridge Road · Ellicott City, Maryland 21043

Phone: (410) 203-9501 · Fax: (410) 203-1441

Email: parkviewellocott@sheltergrp.com



EQUAL HOUSING  
OPPORTUNITY

# Floor Plans & Directions

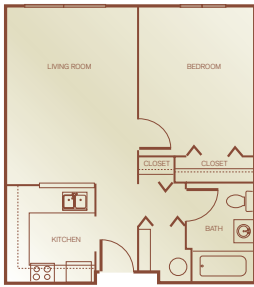

**Unit 1B**  
1 Bedroom, 1 Bath  
562 Square Feet

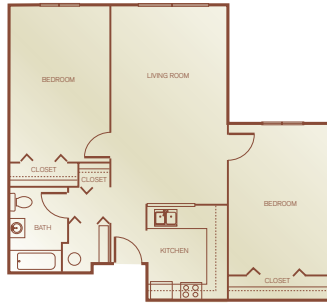

**Unit 2A**  
2 Bedroom, 1 Bath  
900 Square Feet

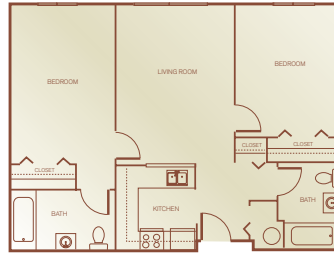

**Unit 2E**  
2 Bedroom, 2 Bath  
839 Square Feet

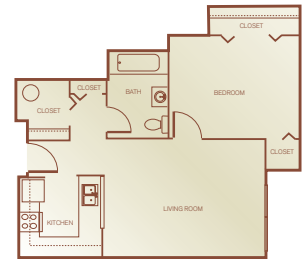

**Unit EFF**  
1 Bedroom, 1 Bath  
580 Square Feet

<i>Apartment Availability</i>
<i>Available Apartment</i>
<i>Monthly Rent</i>
<i>Security Deposit</i>
<i>Application Fee</i>

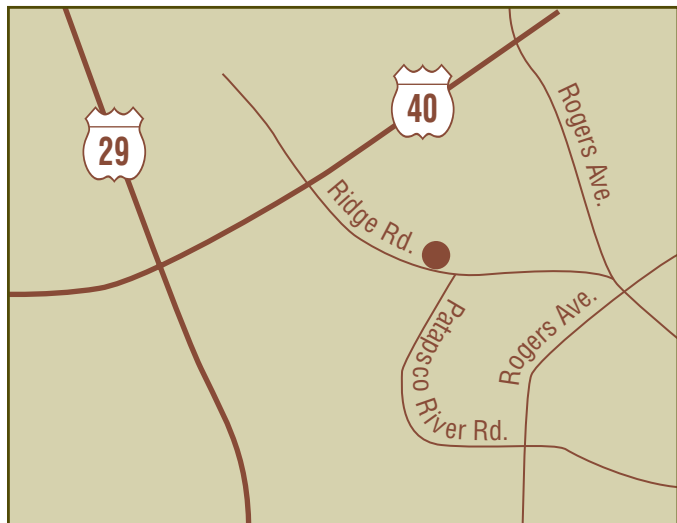

Take Route 40 West towards Ellicott City. Prior to Route 29, turn left onto Ridge Road. Park View at Ellicott City is on the left, just past the post office.

*Park View is committed to Equal Housing Opportunities for people of all races, religions, ethnic groups, sexual orientation and disabilities, and all others protected by federal, state, or local law.*

## ***Park View at Ellicott City***

8720 Ridge Road · Ellicott City, Maryland 21043

Phone: (410) 203-9501 · Fax: (410) 203-1441

Email: parkviewellicott@sheltergrp.com

